

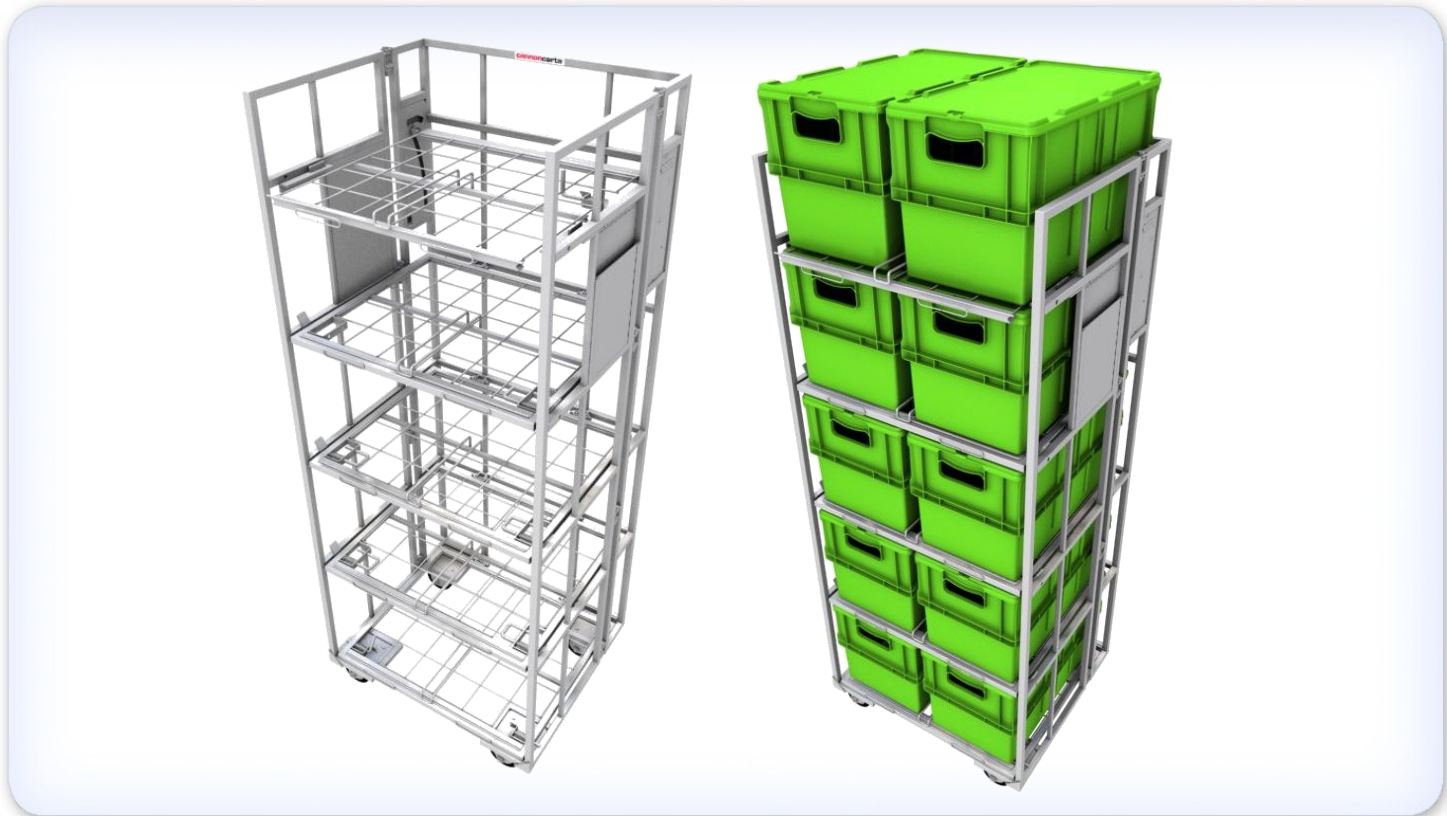

**Custom Cart**



- Distribution**
- Stocking**
- Work-In-Process**
- Display**

This smaller version of the rigid cart 103121-900, is a folding design able to handle totes for over the road delivery. This sturdy and versatile cart can also transport other case goods safely and efficiently. All of the shelves on this cart fold down enabling the entire cart to be collapsed for space savings during backhaul or in the backroom.

The folding design, 400 lb load capacity and four (4) swivel casters of this CannonCart® will make your distribution, stocking or work-in-process operations run smoothly and efficiently.

<b>Depth</b>	25-1/2"	<b>Casters</b>	(4) Performa
<b>Width</b>	28-1/2"	<b>Caster Size</b>	4" x 2"
<b>Height</b>	74-1/4"	<b>Caster Type</b>	4 Swivel
<b>Shelving</b>	5	<b>Finish</b>	Zinc Plated
<b>Number of Sides</b>	3	<b>Load Capacity</b>	400 lbs
<b>Construction</b>	Rigid	<b>Options</b>	Additional Options Available
<b>Cart Weight</b>	150 lbs	<b>Typical Lead Time</b>	5-7 weeks
<b>FOB Point</b>	Cannon Falls, MN		